

CODE	ØB (mm)	E (mm)	A (mm)	H (mm)	Ød (mm)	ØC (mm)	G (mm)	s (mm)	Load Capacity - Fz (Kg)		
									45° Sh.	60° Sh.	70° Sh.
RT-BM-062	62	85	100	30	8,2 x 12,2	50	M 10	2	70	120	155
RT-BM-078	78	110	128	30	9	60.5	M 10	2	110	185	250
RT-BM-092	92	110	130	45	10,2 x 14,2	73.5	M 12	3	135	280	375
RT-BM-106	106	140	170	39	13	88.5	M 12	3	155	350	460
RT-BM-119	119	160	190	50	16,2 x 20,2	93.5	M 16	4	260	530	710

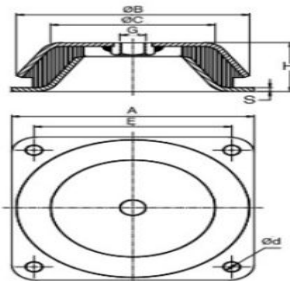

CODE	ØB (mm)	E (mm)	A (mm)	H (mm)	Ød (mm)	ØC (mm)	G (mm)	s (mm)	Load Capacity - Fz (Kg)		
									45° Sh.	60° Sh.	70° Sh.
RT-BM-168	150	132	168	51.5	12.5	110	M 16	4	410	850	1100
RT-BM-184	177	150	184	63	13	126	M 20	4.5	925	1600	2100